

Metric Bushings & Spline Shafts

Manufactured from high quality materials.

They are used where large torsional loads and high axial displacing loads are encountered.

Bushings manufactured to DIN ISO 14-A (DIN 5463-A)

Material: Steel ST 52.3 - non alloy structured steel

Bronze RG 7 (GC-Cu Sn 5/7 Zn Pb)

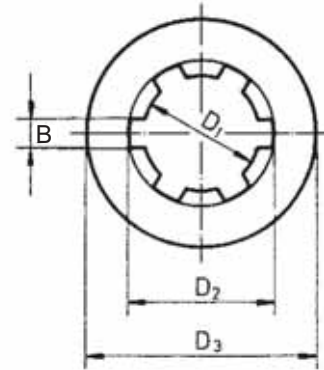
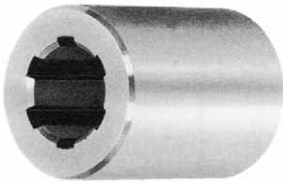

Part No.		Dimensions in mm							Approx. Weight kg.
Steel	Bronze	Profile	Keys	D ₁ H7	D ₂ H11	D ₃	B d9	Length	
00001	00009	A6x11x14	6	11	14	20	3	40	0.07
00002	00010	A6x13x16	6	13	16	28	3.5	45	0.17
00003	00011	A6x16x20	6	16	20	32	4	45	0.20
00004	00012	A6x21x25	6	21	25	40	5	55	0.27
00005	00013	A6x26x32	6	26	32	52	6	60	0.70
00006	00014	A8x32x38	8	32	38	60	6	60	0.88
00007	00015	A8x42x48	8	42	48	65	8	70	0.93

Spline Shafts DIN ISO 14-B (DIN 5463)

Material: Steel C45 AS 1443-1994-1045 - Cold drawn, unhardened

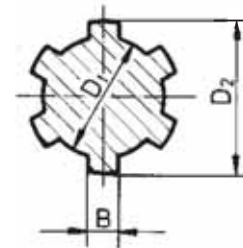
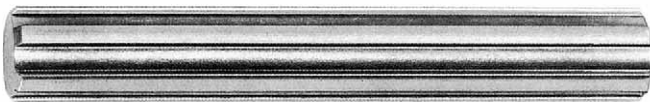

Part No./Length			Dimensions in mm					Weight per mtr. kg.
250mm	500mm	1000mm	Profile	Keys	D ₁ 0-0.08	D ₂ -0.07-0.27	B 0-0.08	
30001/250	30001/500	30001/1000	B6x11x14	6	11	14	3.00	00.95
30002/250	30002/500	30002/1000	B6x13x16	6	13	16	3.50	01.29
30003/250	30003/500	30003/1000	B6x16x20	6	16	20	4.00	01.92
30004/250	30004/500	30004/1000	B6x21x25	6	21	25	5.00	03.14
30005/250	30005/500	30005/1000	B6x26x32	6	26	32	6.00	05.01
30006/250	30006/500	30006/1000	B8x32x38	8	32	38	6.00	07.44
30007/250	30007/500	30007/1000	B8x42x48	8	42	48	8.00	12.38

All dimensions are subject to change without notice.



T.E.A. Machine Components Inc.

Your partner in quality engineering components since 2003

Thank you for downloading product information from TEA's wide range of engineering components.

Now, please contact us for any further information, prices and delivery.

Our contact details are:

T.E.A. Machine Components Inc.
2281-F Dabney Road
Virginia 23230
U.S.A.

Ph: +1-804-342-0004

Fax: +1-804-342-0006

Web: www.teausa.net

Email: sales@teausa.net

You are assured of prompt and efficient service at all times.