

# POLISHED ALUMINUM STAR HANDLE

Type STG - in accordance to DIN 6336

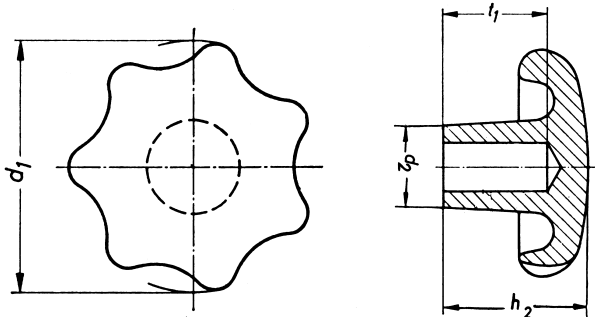

Dimensions in mm

Part No.	d <sub>1</sub>	d <sub>2</sub>	h <sub>2</sub>	t <sub>1</sub>
STG6336-40	40	14	25	18
STG6336-50	50	18	32	21
STG6336-63	63	20	40	25
STG6336-80	80	25	50	32

Blind holes standard.

All sizes generally in stock.

With minimum orders of 50 pieces handles can be ordered with steel inserts for threads or through holes.

# POLISHED LIGHT ALLOY STAR HANDLE

Type KG - in accordance to DIN 6335

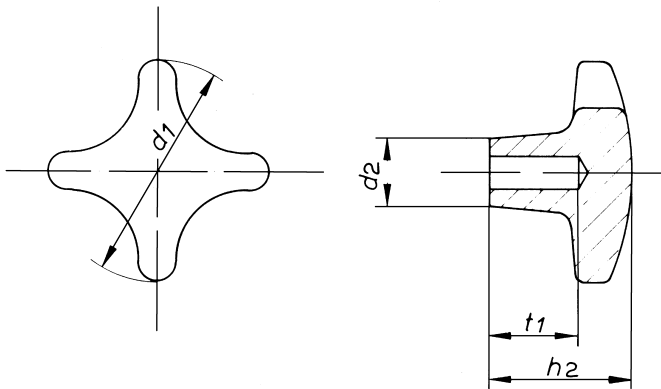

Dimensions in mm

Part No.	d <sub>1</sub>	d <sub>2</sub>	h <sub>2</sub>	t <sub>1</sub>
KG-DIN6335-40	40	14	25	18
KG-DIN6335-50	50	18	32	21
KG-DIN6335-63	63	20	40	25
KG-DIN6335-80	80	25	50	32

Blind holes standard.

All sizes generally in stock.

With minimum orders of 50 pieces handles can be ordered with steel inserts for threads or through holes.

# POLISHED LIGHT ALLOY ROTATING HANDLE

Type DIN98E - in accordance to DIN 98

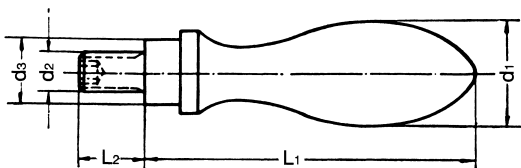

Dimensions in mm

Part No.	d <sub>1</sub>	d <sub>2</sub>	d <sub>3</sub>	L <sub>1</sub>	L <sub>2</sub>
DIN98E16	16	M6	10	54	11
DIN98E20	20	M8	13	67	13
DIN98E25	25	M10	16	83	14
DIN98E32	32	M12	20	105	16

All sizes generally in stock.

All dimensions are subject to change without notice.